

INSTALLATION SHEET GMC/Chevy Stepside '99-

TUFF TONNO III™ & Saber TONNO

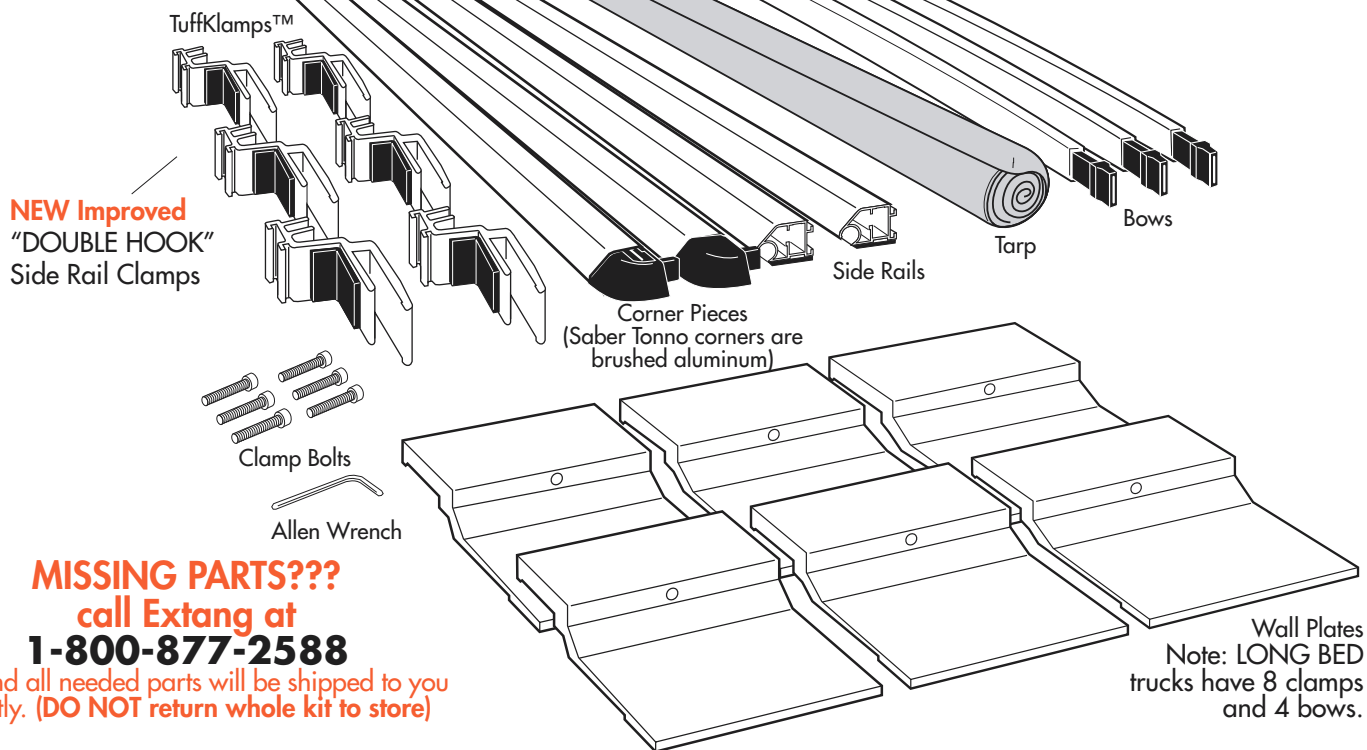

MISSING PARTS???
call Extang at
1-800-877-2588

Any and all needed parts will be shipped to you directly. (DO NOT return whole kit to store)

PARTS INCLUDED IN YOUR KIT. You may want to lay them out in this manner for accessibility.

1

Wash truck bed.

Alcohol Pad

IMPORTANT: Clean here with alcohol pad. (Both Sides)

2

Foam has NO adhesive to touch truck finish.

PLEASE DO NOT LITTER

Remove paper tape from all rails. Discard properly.

3

LeverLock™ (Tuff Tonno III)

ClickLock™ (Saber Tonno)

Depress the mechanism, release, and remove one corner from cab rail.

Feed tarp dowl into cab rail. (NOTE: For easiest feeding action, place tarp on a flat smooth surface, and keep dowl straight while feeding into cab rail. Caution, pavement may scuff tarp.)

Reinsert corner piece into cab rail until it "clicks" and locks into place.

4

Off the truck bed, connect the end rails to the two side rails.

Place assembly over truck box. Center between cab and tailgate.

5

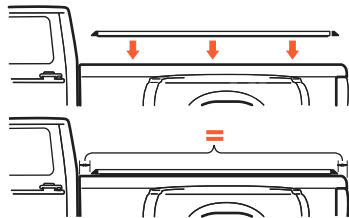

Place the rail assembly over the side of the truck box. Center rails evenly between cab and tailgate. (NOTE: Some applications have hard rubber risers (square rubber pad.) A riser must go toward tailgate. Some applications will have a riser at both ends, (most have no riser).)

When positioning wall plates be sure that they fit correctly against the truck bed wall. The plates must seat against the bottom of, and parallel to, the wall indentation.

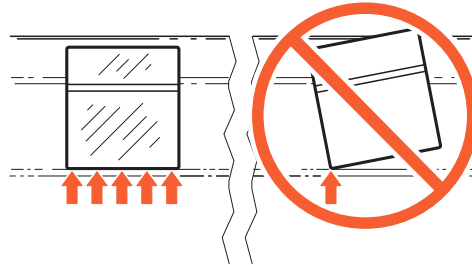
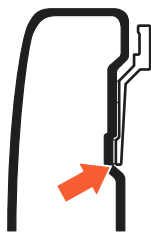

6

Clamp Spacing (Same for each side)

See the stickers located on each side rail for clamp position, or refer to the dimensions given below. Note: Remove stickers after installation.

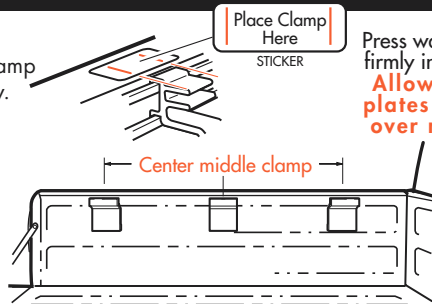
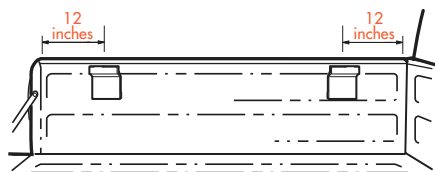

Press wall plate firmly in place. Allow wall plates to set over night.

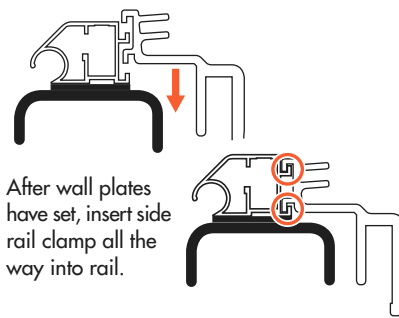

Note: Measure all distances from screw hole centers.

7

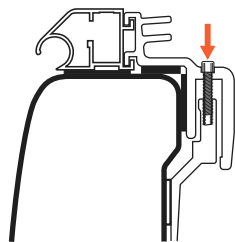

Insert clamp bolt in place. Do Not Overtighten

8

Insert bow onto top or bottom peg. (Top peg for performance, Bottom for good looks.)

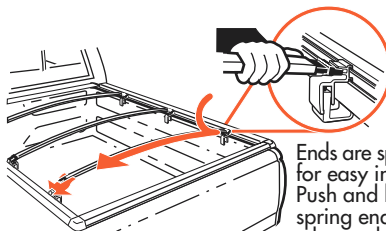

Ends are spring loaded for easy installation. Push and hold on spring end and let the other end slide on with the spring action.



SPECIAL FEATURE: Two pegs offer two height adjustments.

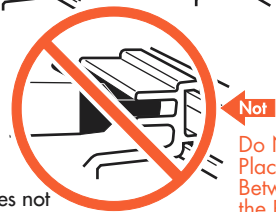

Do Not Place Between the Pegs

Note: Bow End does not fit between pegs.

9

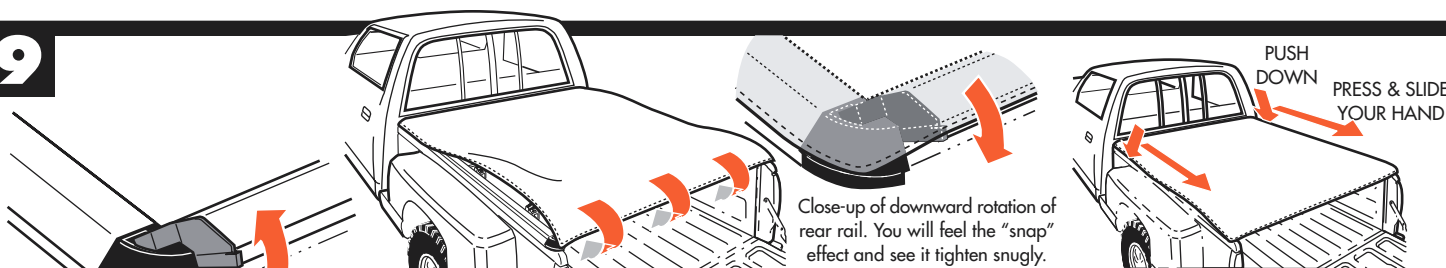

A. Release lever on both corners of tailgate rail and tilt up rail.

B. Attach tarp at front by pressing down on edge of tarp with the palms of your hands (about only 12 inches on each side). Then hook tarp to the tails rail's groove and click down to tighten tarp. See close-up.

C. Finish attaching tarp along each side by pushing down and sliding your hand towards each corner. You can feel the "grip" action.

For Tuff Tonno III:
For Saber Tonno:

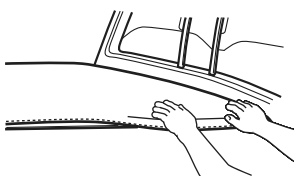

A. Attach tarp from front corner (12 inches) Repeat for each side. Note: Pull tarp out while pressing down in center of the side strip to flex hook open for easy attachment.

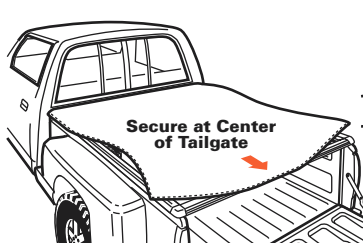

B. Secure tarp at the middle of tailgate rail.

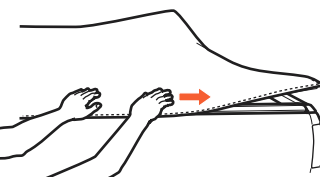

C. Finish attaching tarp along each side by pushing down and sliding your hand front to rear, and on tailgate rail, by pressing out from the center.

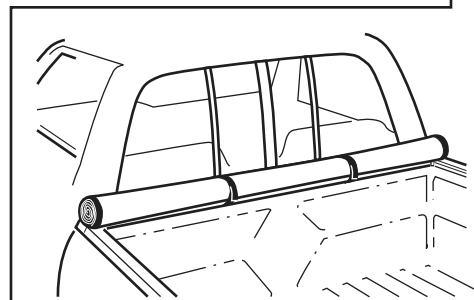

EASY USE OF TRUCK BED

Tarp may be rolled up and secured with Velcro® for bulk hauling