

See Part Descriptions on Back

NOTE: To order, xxx represents the 3-digit application # (vehicle type) following the 1- or 2-digit prefix, as referenced on the vehicle application list or sales receipt. Or call our Customer Service Department at 1-800-877-2588 for assistance.

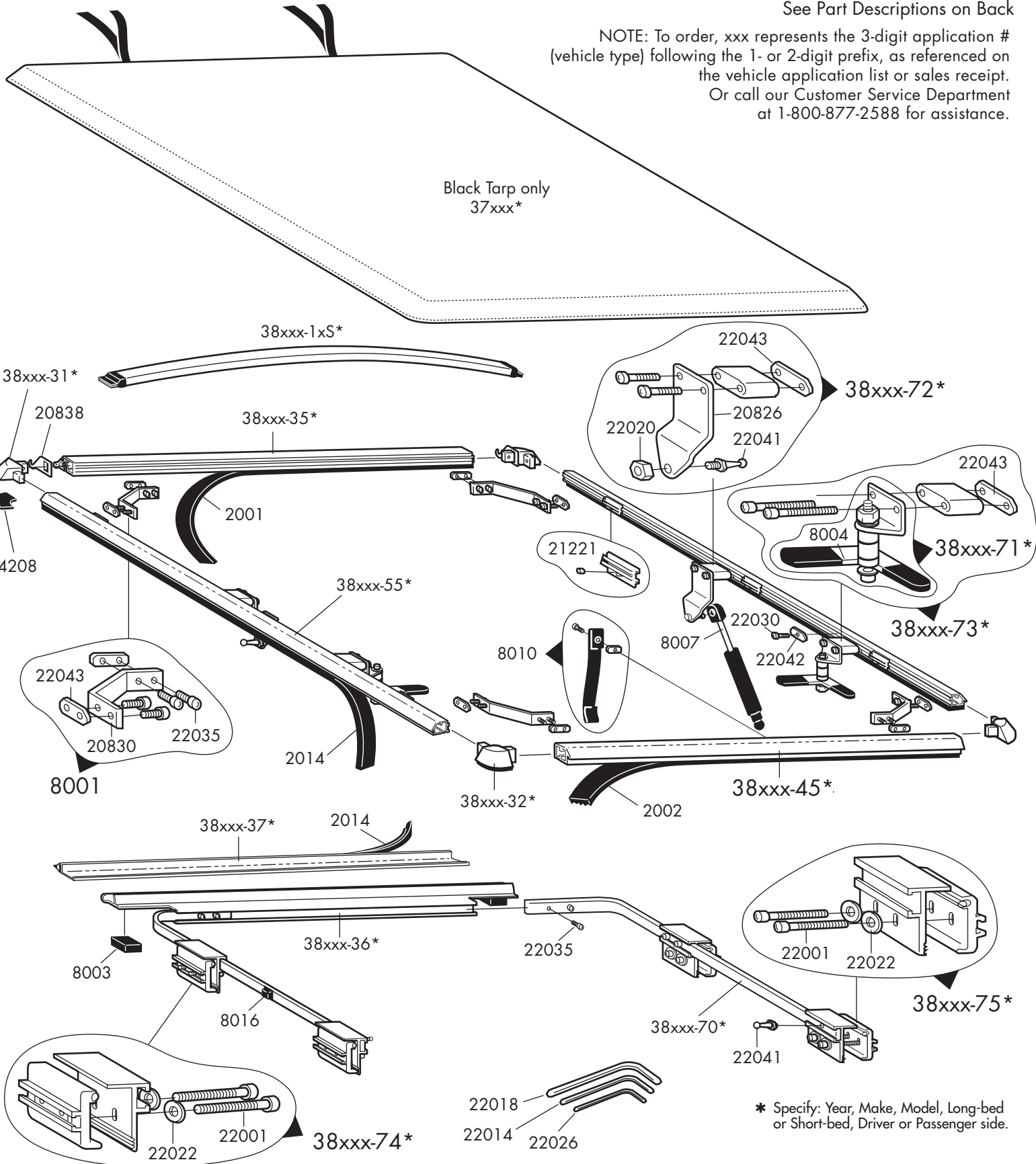

* Specify: Year, Make, Model, Long-bed or Short-bed, Driver or Passenger side.

NOTE: To order, xxx represents the 3-digit application # (vehicle type) following the 1- or 2-digit prefix, as referenced on the vehicle application list or sales receipt. Or call our Customer Service Department at 1-800-877-2588 for assistance.

- | | |
|--|---|
| <p>37xxx* Black FullTilt Replacement Tarp</p> <p>38xxx-10S* Cab Bow w/Bow Ends (1)</p> <p>38xxx-11S* Center Bow w/Bow Ends (S Bed) (1)</p> <p>38xxx-12S* Cab Center Bow w/Bow Ends (L Bed) (1)</p> <p>38xxx-13S* Tail Center Bow w/Bow Ends (L Bed) (1)</p> <p>38xxx-14S* Tail Bow w/Bow Ends (1)</p> <p>38xxx-31* Front Replacement Corner (2)</p> <p>38xxx-32* Rear Replacement Corner (2)
4208 Replacement Corner Pads (4)</p> <p>38xxx-35* Upper Pivot (Cab) Rail Assembly
2001 Cab Rail Foam Strip (30 ft.)
20838 Cab Rail Hinge Lock (1)</p> <p>38xxx-36* Lower Pivot Rail
8003 Pivot Rail Foam Pad (2)</p> <p>38xxx-37* L Channel (for Toolbox Installation only)
2014 L Channel Seal</p> <p>38xxx-45* Tailgate Rail Assembly
2002 Tailgate Foam Strip (6 ft.)</p> <p>38xxx-55* Side Rail Assembly (1)
2014 Side Rail Foam Strip (8 ft.)
21221 Bow Clip w/Screw (2)
22030 1/4"-20x3/4" SHCS (1)
22042 Weld Nut (1)</p> <p>38xxx-70* "L" Rod (1)
8016 "L" Rod Bumper (1)</p> <p>38xxx-72* Shock Stand-off Assembly (1)
20826 Shock Stand-off Bracket (1)
22020 5/16 Nylon Nut
22041 10mm Ball Stud (1)
22043 Weld Nut (1)</p> <p>38xxx-73* Latch Stand-off Assembly (1)
38xxx-71* Latch Assembly (1)
8004 Latch w/Sleeves
22043 Weld Nut (1)</p> | <p>38xxx-74* Front Clamp Assembly (1)
22001 5/16-138x13/4 SHCS (1)
22022 1/4" Washer (1)</p> <p>38xxx-75* Rear Clamp Assembly (1)
22001 5/16-18x13/4 SHCS (1)
22022 1/4" Washer (1)</p> <p>8001 Corner Brace Assembly (1)
20830 Corner Brace
22043 Weld Nut (1)
22035 1/4"-20x3/8" SHCS (1)</p> <p>8007 Gas Shock (1)</p> <p>8010 Pull-Down Strap w/Fasteners</p> <p>Miscellaneous</p> <p>22014 3/16" Hex Key (1)</p> <p>22018 1/4" Hex Key (1)</p> <p>22026 3/32" Hex Key (1)</p> |
|--|---|

* Specify: Year, Make, Model, Long-bed or Short-bed, Driver or Passenger side.